

WEDGE PRESS

RIGHT OPENING - AUTOMATIC FLATBREAD PRESS

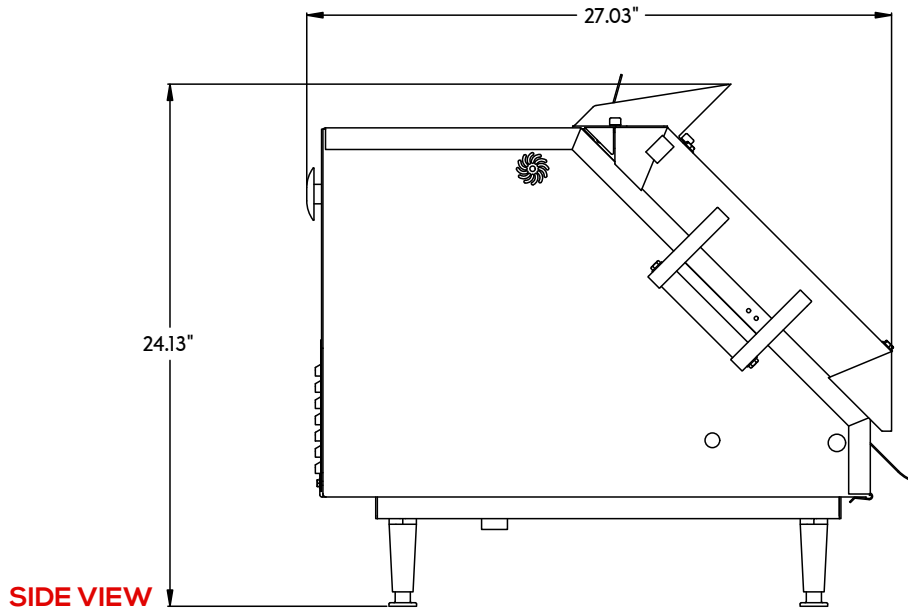

AUTOMATIC

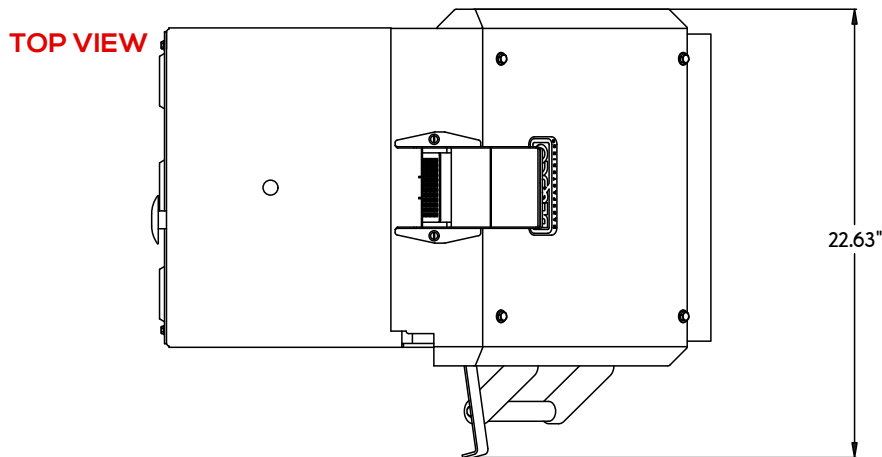

900/HR.
HIGH PRODUCTION





AUTO-EJECTED PRODUCT



DIAMETER FROM
4" TO 12"



NON-STICK

VOLTS	220V/240V	WEIGHT	200LBS.
AMPS	23.4	DIMENSIONS	27.03" L X 22.63" W X 24.13" H
CYCLES	60HZ	ELECTRICAL	 PLUG: NEMA 10-50P (250V~)  RECEPTACLE: NEMA 10-50R (250V~)
PHASE	SINGLE	POWER	5600 WATTS



*Production may vary due to the operator experience, diameter and thickness of product.

BE&SCO EQUIPMENT IS SOLELY INTENDED FOR USE IN A COMMERCIAL FACILITY.



REVISED: 01/22/2021